

ANCLAJES DE MARTILLO DIN 7992

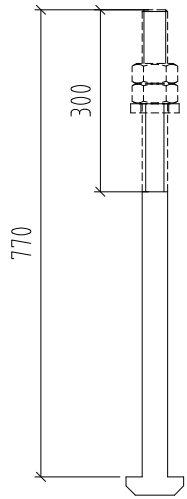

M 42 x 770 mm DIN 7992 - 8.8

16 uds V1

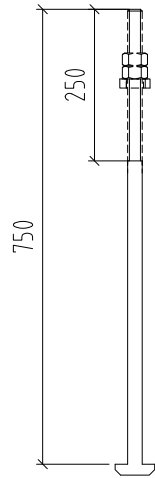

M 24 x 750 mm DIN 7992 - 8.8

24 uds V2

32 uds V3

12 uds V5

8 uds V6

TOTAL 76 UDS

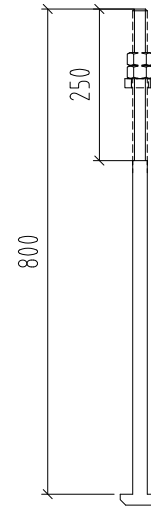

M 24 x 800 mm DIN 7992 - 8.8

20 uds V4

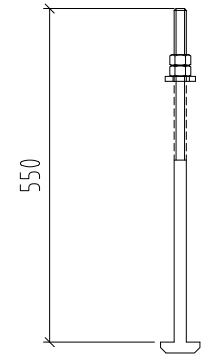

M 20 x 550 mm DIN 7992 - 4.6

6 uds V7