

info@kipp.co

DIN
706 054. B

BALL LOCK PINS

1

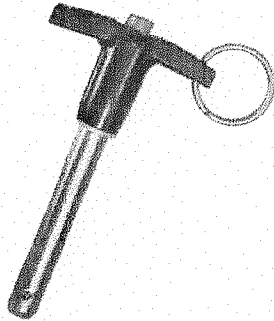

T Handle

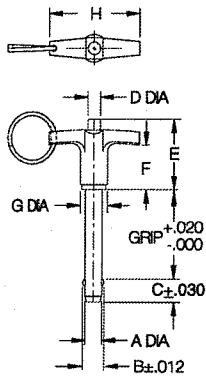

BLPT

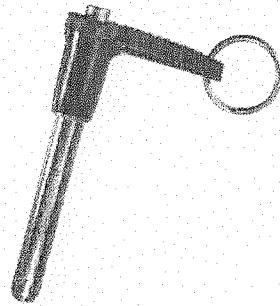

L Handle

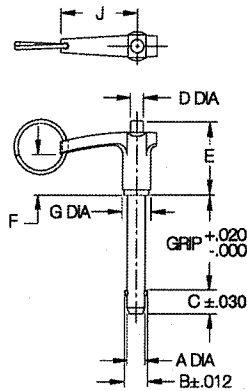

BLPL

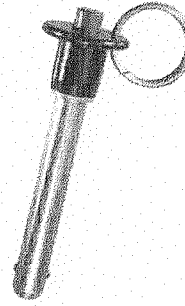

Button Handle

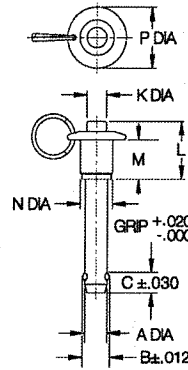

BLPB



Ring Handle

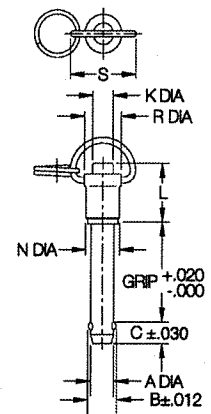

BLPR

INCH

PART NO.	A DIA		B	C	D DIA	E	F	G DIA	H	J	K DIA	L	M	N DIA	P DIA	R DIA	S
	NOMINAL	ACTUAL															
CL- 3-BLPx-x.xx	3/16 (#10)	.1885/.1870	.219	.245	.22	1.26	.78	.47	1.75	1.50	.22	1.26	.89	.47	.82	.57	1.13
CL- 4-BLPx-x.xx	1/4	.2485/.2470	.290	.275	.22	1.26	.78	.47	1.75	1.50	.22	1.26	.89	.47	.82	.57	1.13
CL- 5-BLPx-x.xx	5/16	.3110/.3095	.375	.315	.27	1.47	.94	.59	2.00	1.62	.27	1.47	1.02	.59	1.00	.69	1.13
CL- 6-BLPx-x.xx	3/8	.3735/.3720	.438	.350	.27	1.47	.94	.59	2.00	1.62	.27	1.47	1.02	.59	1.00	.69	1.13
CL- 7-BLPx-x.xx	7/16	.4360/.4345	.508	.365	.39	1.61	1.06	.75	2.25	1.88	.39	1.61	1.08	.75	1.31	.82	1.33
CL- 8-BLPx-x.xx	1/2	.4985/.4970	.592	.445	.39	1.61	1.06	.75	2.25	1.88	.39	1.61	1.08	.75	1.31	.82	1.33
CL- 9-BLPx-x.xx	9/16	.5610/.5595	.666	.495	.50	1.81	1.06	.93	3.00	2.50	.50	1.81	1.25	.93	1.56	1.01	1.33
CL-10-BLPx-x.xx	5/8	.6235/.6220	.750	.565	.50	1.81	1.06	.93	3.00	2.50	.50	1.81	1.25	.93	1.56	1.01	1.33
CL-12-BLPx-x.xx	3/4	.7485/.7470	.886	.655	.71	2.07	1.25	1.31	3.50	2.90	.71	2.07	1.49	1.31	2.16	1.41	1.90
CL-14-BLPx-x.xx	7/8	.8735/.8720	1.044	.745	.71	2.07	1.25	1.31	3.50	2.90	.71	2.07	1.49	1.31	2.16	1.41	1.90
CL-16-BLPx-x.xx	1	.9985/.9970	1.217	.875													

METRIC

CLM-5-BLPx-xx	5mm	.1954/.1939	.212	.245	.22	1.26	.78	.47	1.75	1.50	.22	1.26	.89	.47	.82	.57	1.13
CLM-6-BLPx-xx	6mm	.2347/.2332	.278	.275	.22	1.26	.78	.47	1.75	1.50	.22	1.26	.89	.47	.82	.57	1.13
CLM-8-BLPx-xx	8mm	.3135/.3120	.371	.315	.27	1.47	.94	.59	2.00	1.62	.27	1.47	1.02	.59	1.00	.69	1.13
CLM-10-BLPx-xx	10mm	.3922/.3907	.469	.350	.27	1.47	.94	.59	2.00	1.62	.27	1.47	1.02	.59	1.00	.69	1.13
CLM-12-BLPx-xx	12mm	.4709/.4694	.567	.445	.39	1.61	1.06	.75	2.25	1.88	.39	1.61	1.08	.75	1.31	.82	1.33
CLM-16-BLPx-xx	16mm	.6284/.6269	.748	.565	.50	1.81	1.06	.93	3.00	2.50	.50	1.81	1.25	.93	1.56	1.01	1.33
CLM-20-BLPx-xx	20mm	.7859/.7844	.948	.795													

FX →

705 823.D
DIN 6319

SPHERICAL WASHERS

STEEL: 12L14, CARBURIZED-HARDENED, BLACK OXIDE FINISH
STAINLESS STEEL: 300-SERIES, PASSIVATED

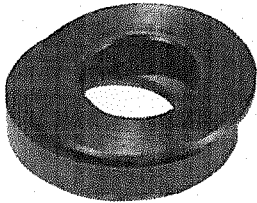

Two-piece washer that compensates whenever a stud and clamp strap are not perpendicular. The top washer has a convex spherical radius, while the bottom washer has a matching concave spherical radius.

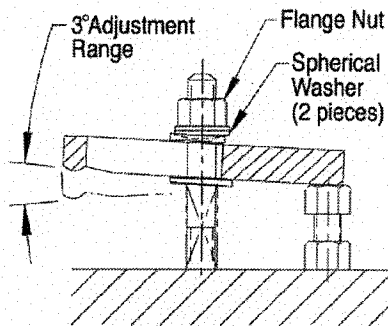
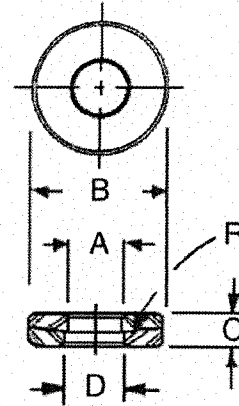

STEEL

PART NO.	BOLT SIZE	A DIA	B DIA	C	D DIA	R
CL-1-SW	1/4 & M6	9/32	5/8	3/16	5/16	3/4
CL-11-SW	5/16 & M8	11/32	3/4	1/4	3/8	1
CL-2-SW	3/8 & M10	13/32	7/8	1/4	7/16	1-1/4
CL-3-SW	1/2 & M12	17/32	1-1/8	5/16	9/16	1-1/2
CL-4-SW	5/8 & M16	21/32	1-3/8		11/16	1-3/4
CL-5-SW	3/4 & M18	25/32	1-5/8	3/8	7/8	2-1/4
CLM-20-SW	M20	.83			7/8	
CL-6-SW	7/8 & M22	15/16	1-3/4	1/2	1	2-1/2
CL-7-SW	1 & M24	1-1/16	2		1-1/8	
CL-8-SW	1-1/8	1-3/16	2-1/4	1/2	1-1/4	3
CL-9-SW	1-1/4 & M30	1-5/16	2-5/8		1-3/8	
CL-10-SW	1-1/2 & M36	1-9/16	2-7/8	1-5/8		

4x →

STAINLESS STEEL

PART NO.	BOLT SIZE	A DIA	B DIA	C	D DIA	R
CL-144	#10 & M5	7/32	1/2	1/8	1/4	3/4
CL-145	1/4 & M6	9/32	5/8	3/16	5/16	
CL-146	5/16 & M8	11/32	13/16	7/32	3/8	1
CL-147	3/8 & M10	13/32	1	1/4	7/16	1-1/4
CL-148	1/2 & M12	17/32	1-1/8	5/16	9/16	1-1/2
CL-149	5/8 & M16	21/32	1-3/8		11/16	1-3/4
CL-150	3/4 & M18	25/32	1-5/8	3/8	7/8	2-1/4