

Change Information	Location	Change Description	A = Added D = Deleted	W = Was	Document Release Status RELEASED
19079		See CI			Date 2018-03-19 Modification Count

FLANGE SCREWS

M-threads
Steel, property class 8.8
Treated Y 1000-4, colour black
Small widths across flats

REQUIREMENTS

Material

Steel, property class 8.8 STD 7121,11.

Surface treatment

Treated Y 1000-4 colour black STD 121-0003.
Electrolytic surface treatment.

Others

Thread tolerance class 6e.
Wrenching height and corner fill of hexagon STD 7121,23.
Max. surface discontinuities STD 7121,13.
Geometrical tolerances STD 7121,221.
Symbols, designations and general drawing methods STD 101-0005.

The copying, distribution and utilization of this document as well as the communication of its contents to others without expressed authorization is prohibited. Offenders will be held liable for payment of damages. All rights reserved in the event of the grant of a patent, utility model or ornamental design registration.

Document Title
FLANGE SCREW

VOLVO

Volvo Corporate Standards

Document Type
MULTI-PART DEFINITION

Owner Domain:Document Prefix

Document No 1058561	Issue Index 019	Volume No	Page No 1 (5)
-------------------------------	---------------------------	-----------	-------------------------

Dimensions

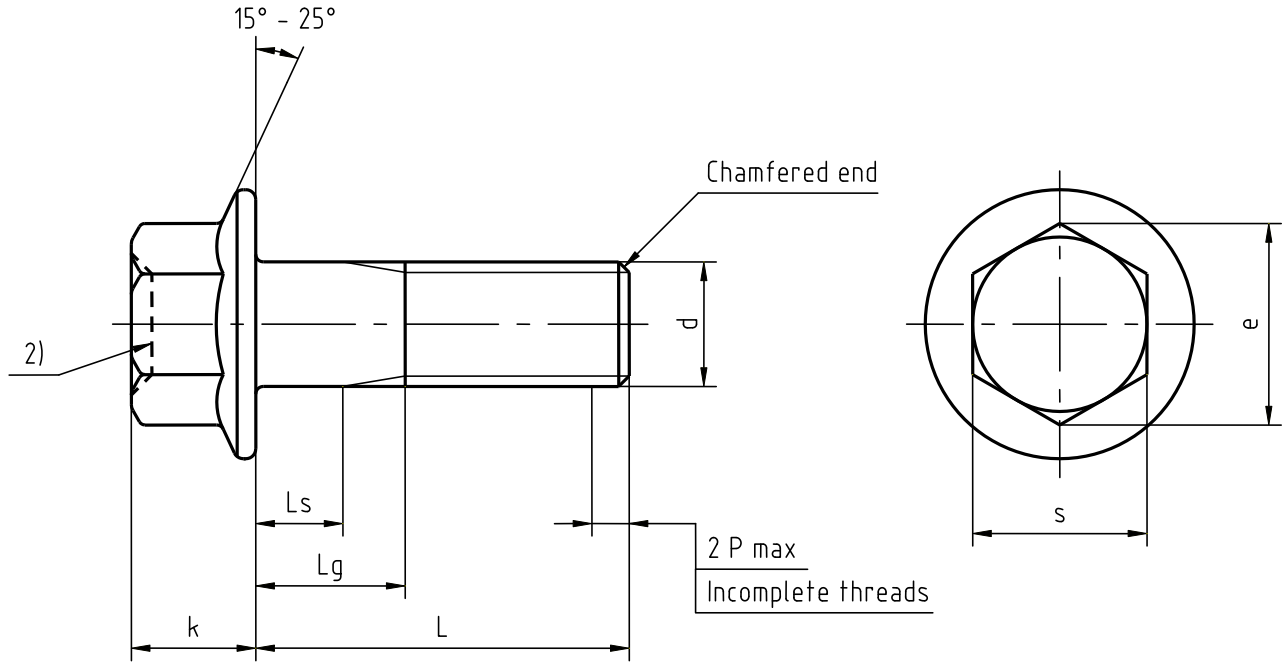

Thread run-out dimensions for fully threaded screw and flange.

Dimensions for under head fillet for partially threaded screw.

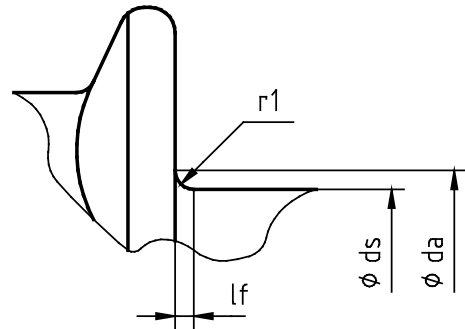
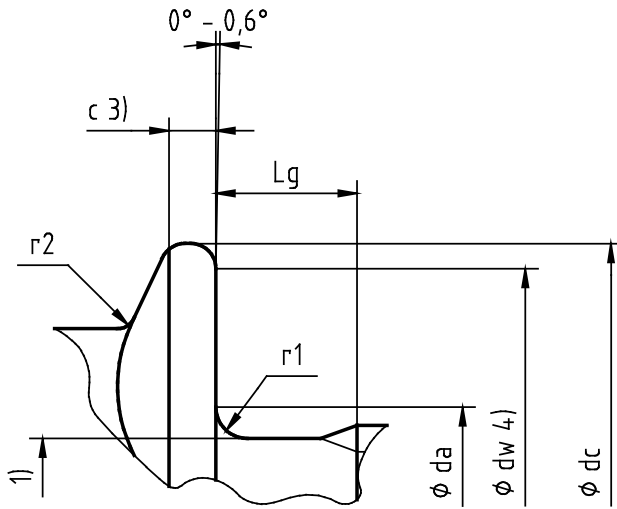

- 1) \approx thread pitch diameter
- 2) Top of the head may alternatively be recessed.
- 3) Measured at $dw \text{ min}$ as per table.
- 4) Diameter bearing surface.

VOLVO

Volvo Corporate Standards

Document Title
FLANGE SCREW

Document Type
MULTI-PART DEFINITION

Document No
1058561

Issue Index
019

Volume No

Page No

2 (5)

Thread d			M5			M6		
P pitch			0,8			1		
ds			max 5			6		
			min 4,82			5,82		
c 1)			min 1			1,1		
da			max 5,7			6,8		
lf			max 1,4			1,6		
dc			max 11,4			13,6		
dw 2)			min 9,4			11,6		
e			min 7,59			8,71		
k			max 5,6			6,9		
r1			min R 0,2			R 0,25		
r2			max R 0,3			R 0,4		
s			max 7			8		
			min 6,78			7,78		
L (js 15)			Ls	Lg	Part No.	Ls	Lg	Part No.
nom	min	max	min	max	max	min	max	
8	7,71	8,29				-	3	60112518 P01
10	9,71	10,29	-	2,4	996063 P03	-	3	984723 P02
12	11,65	12,35	-	2,4	996062 P03	-	3	984724 P02
(14)	13,65	14,35				-	3	994372 P01
16	15,65	16,35	-	2,4	996061 P03	-	3	984725 P04
20	19,58	20,42	-	2,4	996255 P03	-	3	984726 P02
(22)	21,58	22,42				-	3	994373 P01
25	24,58	25,42	5	9	60111965 P02	-	3	984727 P02
30	29,58	30,42	10	14	60111966 P02	7	12	984728 P02
35	34,5	35,5	15	19	60111967 P02	12	17	994374 P01
40	39,5	40,5	20	24	60112515 P02	17	22	984729 P02
45	44,5	45,5				22	27	994375 P01
50	49,5	50,5				27	32	984730 P02
55	54,5	55,5	35	39	60112516 P02	32	37	994376 P01
60	59,4	60,6	40	44	60112517 P02	37	42	984731 P02
65	64,4	65,6				42	47	994377 P01
70	69,4	70,6				47	52	60112519 P01
(75)	74,4	75,6				52	57	994378 P01
80	79,4	80,6				57	62	994379 P01
90	89,3	90,7				67	72	994380 P01
100	99,3	100,7				77	82	994381 P01

1) Measured at dw min as per table.

2) Diameter of bearing surface.

Lengths within brackets are not recommended.

VOLVO

Volvo Corporate Standards

Document Title

FLANGE SCREW

Document Type

MULTI-PART DEFINITION

Document No

1058561

Issue Index

019

Volume No

Page No

3 (5)

Thread d			M7		M8			
P pitch			1		1,25			
ds			max 7		8			
			min 6,78		7,78			
c 1)			min		1,1			
da			max		8			
lf			max		2			
dc			max		15,1			
dw 2)			min		13,1			
e			min		10,95			
k			max		7,6			
r1			min		R 0,4			
r2			max		R 0,5			
s			max		10			
			min		9,78			
L (js 15)			Ls	Lg	Part No.	Ls	Lg	Part No.
nom	min	max	min	max		min	max	
10	9,71	10,29				-	3,75	994382 P01
12	11,65	12,35				-	3,75	984732 P02
(14)	13,65	14,35	-	3	60113850 P01	-	3,75	994383 P01
16	15,65	16,35				-	3,75	984733 P02
20	19,58	20,42	-	3	60112829 P01	-	3,75	984734 P02
(22)	21,58	22,42				-	3,75	994384 P01
25	24,58	25,42				-	3,75	984735 P02
30	29,58	30,42				-	3,75	984736 P02
35	34,5	35,5				-	3,75	984737 P03
40	39,5	40,5				11,75	18	984738 P02
45	44,5	45,5				16,75	23	994385 P01
50	49,5	50,5	25	30	996064 P01	21,75	28	984739 P02
55	54,5	55,5				26,75	33	994386 P01
60	59,4	60,6				31,75	38	984740 P02
65	64,4	65,6				36,75	43	994387 P01
70	69,4	70,6				41,75	48	984741 P02
(75)	74,4	75,6				46,75	53	994388 P01
80	79,4	80,6				51,75	58	984742 P02
(85)	84,3	85,7				56,75	63	994389 P01
90	89,3	90,7	65	70	996065 P01	61,75	68	984743 P02
95	94,3	95,7				70	75	996066 P01
100	99,3	100,7				71,75	78	984744 P02
110	109,3	110,7				81,75	88	984745 P02
(115)	114,3	115,7				82,75	89	994390 P01
120	119,3	120,7				91,75	98	984746 P02
130	129,2	130,8				95,75	102	984747 P03
140	139,2	140,8				105,75	112	984748 P03
150	149,2	150,8				115,75	122	984749 P03
170	169,2	170,8				135,75	142	984750 P03
190	189,1	190,9				155,75	162	996144 P01

1) Measured at dw min as per table.

2) Diameter of bearing surface.

Lengths within brackets are not recommended.

VOLVO

Volvo Corporate Standards

Document Title

FLANGE SCREW

Document Type

MULTI-PART DEFINITION

Document No

1058561

Issue Index

019

Volume No

Page No

4 (5)

INFORMATION

The dimensions agrees with ISO 15071:1999.

VOLVO

Volvo Corporate Standards

Document Title

FLANGE SCREW

Document Type

MULTI-PART DEFINITION

Document No

1058561

Issue Index

019

Volume No

Page No

5 (5)