

d	D [mm]	a [mm]	h [mm]	b [mm]	kg	Note
M16	16	60	190	150	0.7	UM16*60*h/b
		60	400	200	1.4	
M20	20	80	190	60	1.2	UM20*80*h/b
			250	100	1.5	
			350	100	2.0	
M24	24	80	250	100	2.2	UM24*80*h/b
			350	100	2.9	
			400	100	3.3	
			450	100	3.6	
M27	27	100				UM27*100*h/b
M30	30	100	250	100	3.7	UM30*100*h/b
			350	100	4.8	
			450	100	5.9	
M33	33	100	350	150	5.3	UM33*100*h/b
M36	36	100	350	150	6.9	UM36*100*h/b
			400	150	7.7	
			500	150	9.3	
M42	42	140	350	150		UM42*140*h/b
			400	150		
			450	150		
			500	150		

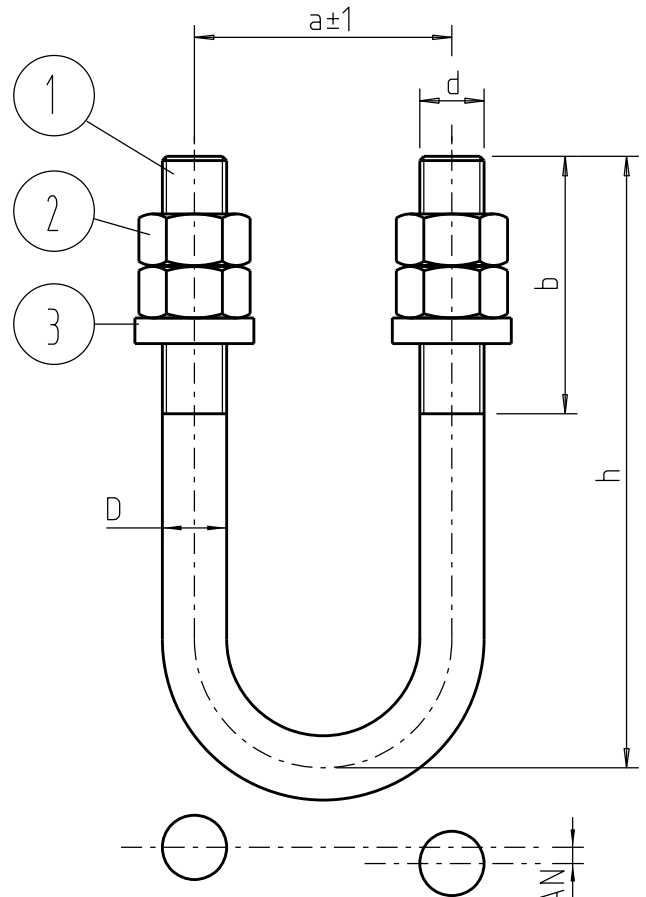

BENDING IN LIGHT REDGLOW,
TEMP. BETWEEN 1000-900 °C
COOLING FREELY IN AMBIENT TEMPERATURE

DIAMETER OF BAR ACC. TO DIMENSION D (TABLE)
HOT DIP GALVANIZING SFS-EN ISO 1461
UNDERSIZED GALVANIZING FOR THREADS, SFS 4449

INCLINATION FROM PLAN
MAX. 1 mm IN 100 mm

PART	NAME	QUALITY OR DRAWING / STANDARD	MASS	PCS
3	WASHER	Fe, ZnK	DIN 7989	2
2	NUT	8, ZnK	DIN 934	4
1	ROUND STEEL	S355J2	EN 10025-2	1

Rev.	Sheet(s)	Date	Revisions	Drawn	Appr.

	Filename	RAS2AE095.dgn	Replaces	
			Replaced by	
			Designed MLAA	Date 24.1.2019
			Drawn EVOL	Size
			Appr. MPAA	A4
RAASAKKA 110kV PORTAL h=12m U-BOLT STRUCTURAL DRAWING			Drawing number RAS-2-AE-095	Rev. TA01
	Sheet	1	Sheets	1
				Scale 1: 2,5