

14

13

12

11

SPECIAL CHARACTERISTICS		
NO. & TYPE	DESCRIPTION	LOCATION
-	-	-
-	-	-

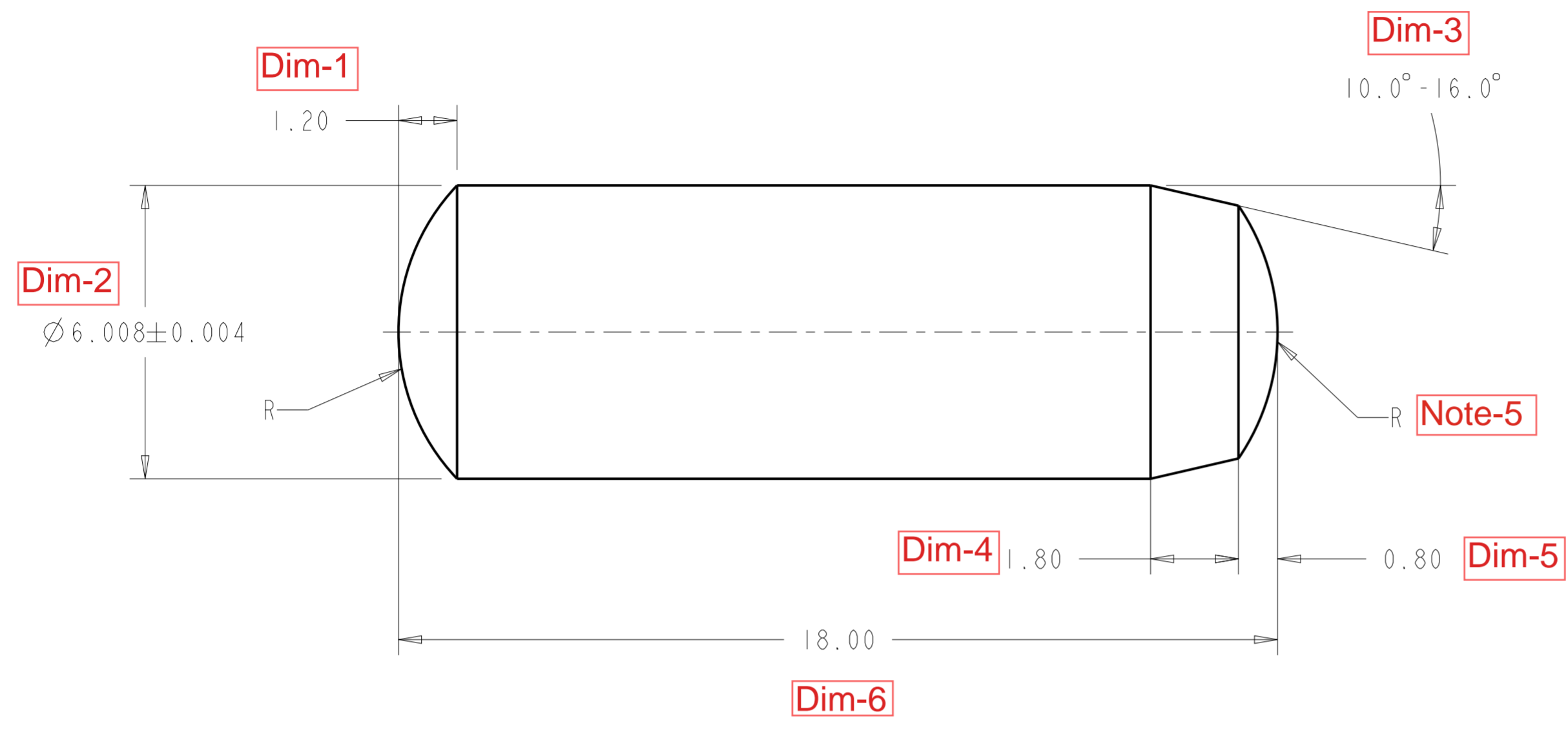

- Note-4** 4. CLEANLINESS PER TES-183 CLASS 1
- Note-3** 3. OPTIONAL MATERIAL: SAE 52100
HARDNESS: 60-64 HRC
- Note-2** 2. UNLESS OTHERWISE SPECIFIED, THIS PART
MUST CONFORM TO DIN EN ISO 8734 TYPE A OR B
- Note-1** 1. MARK PER TES-002-5 WITH PART NO., EATON PLANT
VENDOR IDENTIFICATION, REVISION LEVEL AND DATE CODE

NOTES:

A RELEASED FOR BI PROTOTYPE		AMD	JUL 24
ENG. REL.	-	CHANGE:	REV. A
ENGINEERING REVISIONS			
COPIES OF THIS DOCUMENT ARE NOT CONTROLLED			
UNLESS OTHERWISE SPECIFIED:			
STANDARD MACHINING PRACTICE PER TES-001. DRAWING SPECIFIES THE COMPLETED PART REQUIREMENT. DO NOT SCALE DRAWING ASME Y 14.5M-1994 APPLIES THIRD ANGLE PROJECTION	TOLERANCES- X.X ± 0.5 X.XX ± 0.25 ANGLES ± 0.5° CHAMFERS ± 5°	CASTINGS AND FORGINGS: TOLERANCES ± 0.8 DRAFT- CAST 3° MAX.; FORGED 7° MAX CORNER RADII - 1.5 FILLET RADII - 6.0	
SURFACE TEXTURE 3.2/√			
DESIGN FOR MODEL eTV			
PROJECT NO. -			
DRAWN BY AMD	DATE JUL 24	TITLE PIN, DOWEL	
CHECKED BY NM	DATE JUL 24		
ENGR	CH ENGR	MATERIAL	
MET ENGR	GEAR ENGR	2 3	
SCALE 10/1	SIZE		
SHEET 1 OF 1	A2		

MASS: (3.69 g)

UNLESS OTHERWISE SPECIFIED: ALL DIMENSIONS ARE IN MILLIMETERS

REF DRAWING

CHK'D

CREO A2-94-mm

0 10 20 30 40 MILLIMETERS

14

13

12